

Feeder for easy feeding of flat products

Design and characteristic features:

- Feeding width 235 mm standard
- Modular, compact industrial machine design
- Simple, clear and user-friendly
- Single product feeding
- Easy feeding of the products
- Central air gap adjustment from 0.1 up to 5 mm
- Missing sheet detection by product run-time monitoring for
- Min. stack monitoring in the magazine
- Product magazine for loading is easily accessible
- Individual adjustable stack support
- Infinitely adjustable feeding speed up to 40 m/ min
- Drive actuated via DC motor

Control:

- Autonomous microprocessor control
- Protection type IP 40
- Adjustable feeding speed
- Fault message indication by way of illuminated RESET button

OPTIONS:

- Piece counter up to 99 pcs. (not exchangeable)
- Start sensor for external start pulse
- Pulse generator
- Floor stand

EF-235 Friction feeder Technical Data (Standard configuration)

Formats (special formats possible):	min. 80 x 60 mm, max. 300 x 235 mm (short side forward)
Belt speed/ feeding performance (continuous mode / cycled), depending on product:	40 m/min. (continuous) / up to 60 cycles/min. (A5, cycled)
Product passage:	min. 0.1 mm, max. 5 mm, paper quality min. 80 g/m ²
Magazine loading: (depending on the product):	Standard 200 mm, DIN A4 max. 50 mm max. load
Drive:	DC-Motor
Control:	Microprocessor
Supply voltage / Power input:	230 V / 50 Hz, 200 VA

Dimensions (W x D x H) / Weight:	336 x 646 x 320 mm (Feeder + Control + exit extension) / approx. 19 kg
----------------------------------	--

Dimensions EasyFeeder, Feeding width 235 mm:

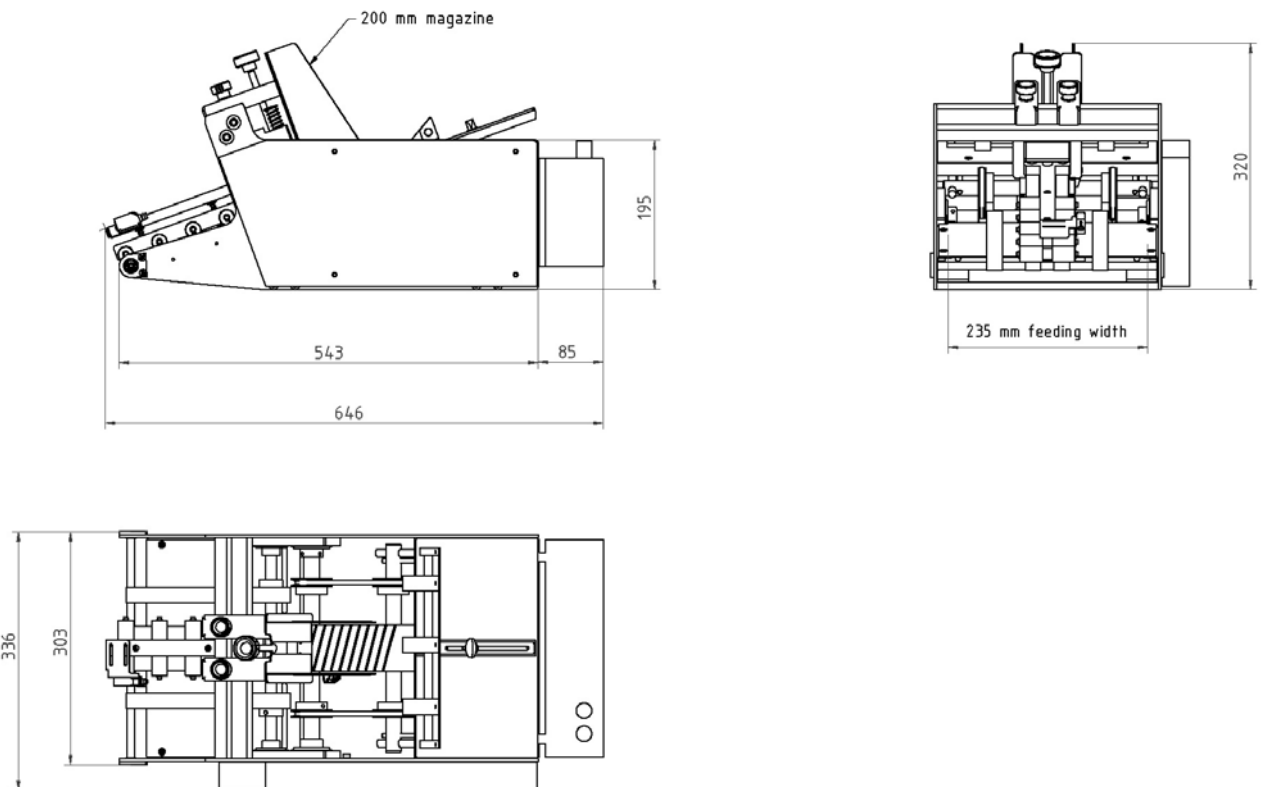

09 / 2009 Subject to technical modifications

Options:

Counter function:	1 – 99 pcs.
Start sensor:	for external start pulse
Pulse generator:	For setting of cycle speed
Floor stand:	Movable and vertically adjustable +/- 50 mm
Level control:	In stacking magazine or autoloader
Additional signal lamp:	For optical error display / status display